

Courses N<sup>o</sup>1 Beginning at a Chestnut Tree a Corner of Benjamin Breneman Christian Rosebaugh Thence as follows

- N<sup>o</sup>1, N 74° E 43.5 p Post.
- N<sup>o</sup>2, S 61° E 66.6 p Post.
- N<sup>o</sup>3, S 48 3/4° W 15.5 p Chest.
- N<sup>o</sup>4, S 35 1/2° W 43 p Stone.
- N<sup>o</sup>5, S 25 1/2° E 89.2 p Post.
- N<sup>o</sup>6, S 67 1/2° W 55.6 p Chest.
- N<sup>o</sup>7, S 42° W 20.1 p Chest.
- N<sup>o</sup>8, S 47° E 12.8 p Post.
- N<sup>o</sup>9, S 46° W 57.8 p Post.
- N<sup>o</sup>10, N 1° W 31.4 p Post.
- N<sup>o</sup>11, N 37° E 36 p Post.
- N<sup>o</sup>12, N 60° E 62.5 p Post.
- N<sup>o</sup>13, N 31° W 46 p Post.
- N<sup>o</sup>14, N 83° W 54 p Post.
- N<sup>o</sup>15, S 75° W 61 p Post.
- N<sup>o</sup>16, N 2° E 80 p Hickly Crab.
- N<sup>o</sup>17, N 00° E 62 p to Beginning

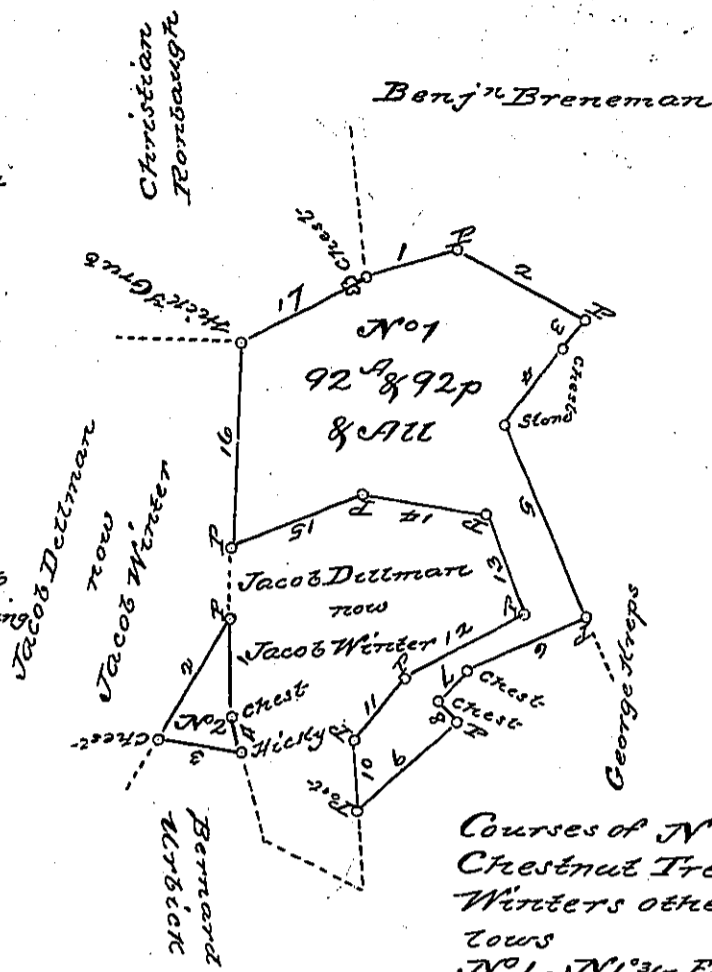

Courses of N<sup>o</sup>2 Beginning at a Chestnut Tree a Corner of Jacob Winters other land thence as follows

- N<sup>o</sup>1 - N 31 1/4° E 43.6 p Post
- N<sup>o</sup>2 - S 31 1/4° W 63 p Chest
- N<sup>o</sup>3 - S 84° E 36.5 p Hickly
- N<sup>o</sup>4 - N 8 1/2° E 15.3 p to the Beginning

Situated in Codorus Township York County & Surveyed the 9<sup>th</sup> Day of November 1786 for Jacob Winters in right of Samuel Breneman In pursuance of a Warrant Dated the 14<sup>th</sup> Day of November 1785, for 40 acres directing the same to be Surveyed in two Pieces N<sup>o</sup>1 92<sup>a</sup> & 92<sup>p</sup> & N<sup>o</sup>1 6<sup>a</sup> & all  
 By Moses McLean Deput.  
 To Jno. Lukens Esq<sup>r</sup>  
 Surveyor Genl.

IN TESTIMONY that the above is a copy of the original remaining on file in the Department of Internal Affairs of Pennsylvania, made conformably to an Act of Assembly approved the 16th day of February, 1833, I have hereunto set my Hand and caused the Seal of said Department to be affixed at Harrisburg, this fifth day of April 1898

*James W. Fatta*  
 Secretary of Internal Affairs.